

H

HERITAGE

by Wolf

PREPROGRAMMED
WATCH WINDER
OWNER'S MANUAL

Congratulations on your purchase of this watch winder. Please review this quick start guide so that your automatic watch will benefit fully from the features that have been engineered into this product.

This appliance can be used by children aged from 8 years and above and persons with reduced physical, sensory or mental capabilities or lack of experience and knowledge if they have been given supervision or instruction concerning use of the appliance in a safe way and understand the hazards involved.

Children shall not play with the appliance. Cleaning and user maintenance shall not be made by children without supervision. Appliance is only to be used with the power supply unit provided with the appliance.

Getting Started

This Module 2.1 winder comes with a power adapter (AC/DC 5.0-volt output) and will also run on “D” cell batteries (with the exception of the 4, 6, and 8-piece winders). The winder will automatically switch to main power if both power sources are connected.

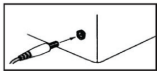
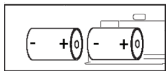

Step 1 - Remove the cuff from the winder drum by pulling firmly on the two tabs. Close the strap or bracelet of your watch. Compress the cuff and slide your watch over the cuff, watch dial facing outwards. Push the cuff into the drum until it locks into place, an audible click will be heard.

Step 2 - With the adapter connected, or batteries installed, turn the knob to the required rotation position. “A” for clockwise rotation, “B” for counterclockwise rotation, or “C” for a combination of both. The rotation cycle program will start 10 seconds after you have selected a rotation setting.

Step 3 - Turn the winder on by selecting the appropriate setting of either “ON” or “12”, as shown on the faceplate of the winder. When “ON” is selected rotation will begin in 10 seconds. When “12” is selected, rotation will begin in 12 hours. Use the 12 hour start delay when your mainspring has sufficient energy, and is not in need of immediate rotations.

To stop the rotation, turn the knob back to “OFF.”

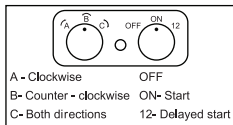

Note that almost all automatic watches will wind properly in the C setting, unless you know that your watch requires something other than the C setting. Please consult the manufacturer of your watch for this information.

Important

Note that this winder will not wind your watch continuously. The computer chip inside has been programmed to wind your watch on an intermittent basis only, with extended 'pause' and 'sleep' phases. This is for the protection of the mainspring of your watch. When your winder is in perfect working order, a green light will flash intermittently from the control dial plate. If the light changes to red, this is indicative of batteries which need replacement.

**For further technical information, visit our website:
www.wolf1834.com**

All WOLF watch winders are made under one or more US and Foreign Patent Nos. For the actual Patent No for your purchased winder, please see Patent No marking on the winder.

© 2020 Wolf Designs Inc. - All rights reserved. All products are proprietary and / or patented by Wolf Designs Inc. Rights will be legally enforced.

Please visit www.wolf1834.com for additional languages.